

incorrect operation. The company reserves the right to amend the details of the instruments with no prior notice. If any mistakes are found in these instructions, please feel free to send us an e-mail informing us so that we can correct them.

- These components are subject to change without prior notice.

- Appearance of product may differ from the image.

No.	PRODUCT	REF.	QTY.
1	GALVANIC HANDLE	10004	2
2	GALVANIC WIRES		1
3	ACCESSORIES GAL-VANIC	-	2
4	ACCESSORIES GAL-VANIC	-	2
5	MAIN UNIT	-	1
6	FEEDER CABLE	-	1



- Never under any circumstances attempt to open or inspect the internal components or accessories of the machine. If an inspection becomes necessary, please contact your supplier or a suitably competent technician..

- Never use the unit in humid or poorly ventilated environments, such as wet rooms, bathrooms etc. to prevent damage to the electrical components of your unit.

- Never use the unit outdoors; exposure to the elements can cause damage.

- If the power cord was destroyed, please ask a professional to service and replace it to avoid hazards, or contact the dealer for service.

- Pacemaker (any electrical or rhythmic heart-regulating device)
- Pregnancy
- Thrombosis/Phlebitis
- Skin diseases
- Operations (within the last 6 months)
- Silicone implants
- Hypersensitive or vascular skin

This product meets the following requirements:

1. Conditions set out in the Low Voltage Directive: 2006/95/EC

2. Conditions set out in the Electromagnetic Compatibility Directive: 2004/108/EC

 Whenever any of our electrical products or their presentation packaging bear this symbol, it means that these products should not be treated as conventional household waste in Europe. To ensure proper treatment of this waste, dispose of it in accordance with local laws or as required for the disposal of electrical equipment. This initiative will help preserve save natural resources and improve standards of environmental protection in regard to the treatment of electrical waste.

Thank you very much for purchase. Please read the instructions carefully before operating the instrument. You can also ask a professional for guidance to make sure you are using the instrument correctly. We will accept no responsibility for any accidents that occur due to

incorrect operation. The company reserves the right to amend the details of the instruments with no prior notice. If any mistakes are found in these instructions, please feel free to send us an e-mail informing us so that we can correct them.

- These components are subject to change without prior notice.

- Appearance of product may differ from the image.

No.	PRODUCT	REF.	QTY.
1	GALVANIC HANDLE	10004	2
2	GALVANIC WIRES		1
3	ACCESSORIES GAL-VANIC	-	2
4	ACCESSORIES GAL-VANIC	-	2
5	MAIN UNIT	-	1
6	FEEDER CABLE	-	1

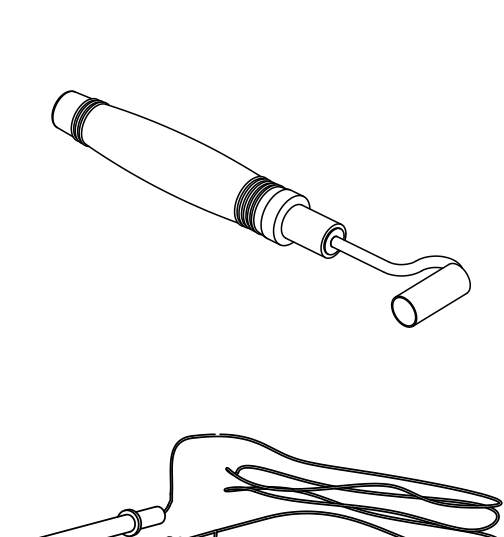

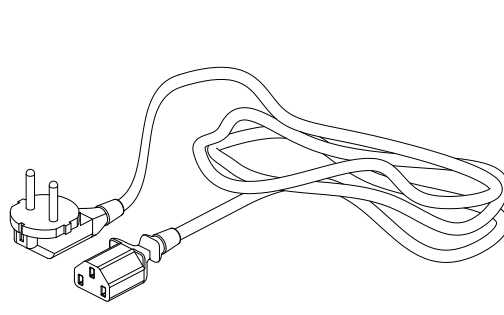
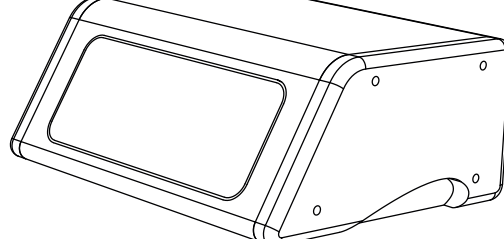
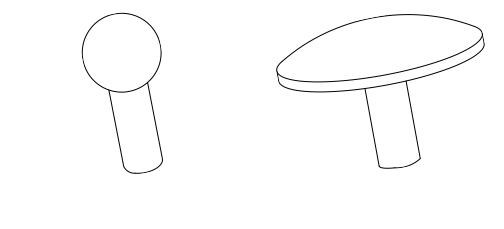

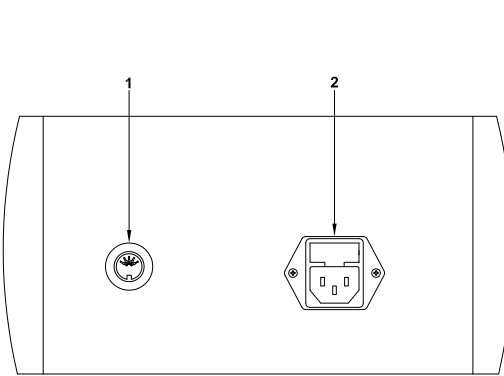
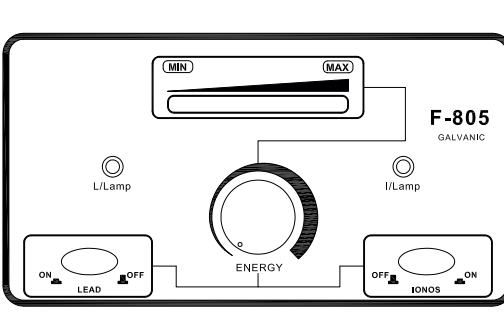

1. Galvanic handle

2. Power line input

1. Connect the power supply via the rear panel, indicated in the sketch as “POWER LINE INPUT”.

2. Connect the accessories properly to the front/rear panel as indicated in the sketch.

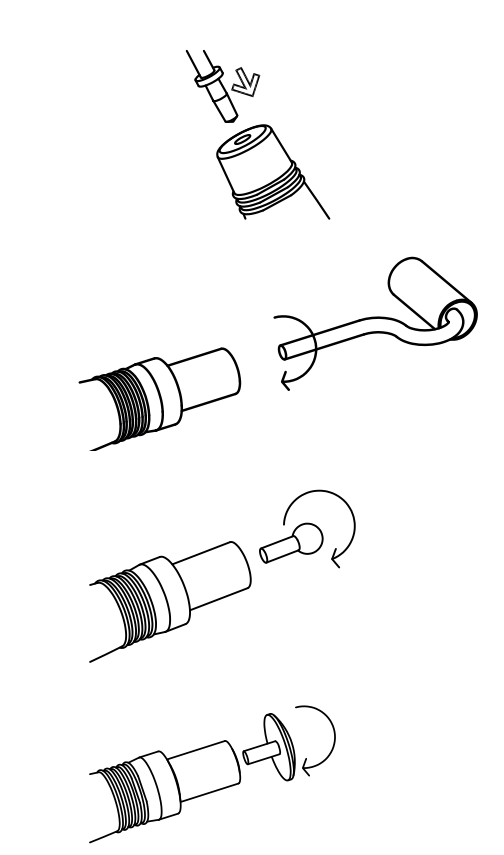

1. The treatment area must be washed and dried before any products can penetrate into the tissue.

2. The customer holds the metal pole and the therapist holds the handle of the roller.

3. The polarity of the probes can be changed by adjusting the “LEAD” button between (+R) or (-G).

Positive pole (anode)	Negative pole (cathode)
+R	-G
Roller/ball (+), metal pole (-)	Roller/ball (-), metal pole (+)
Acid pH solutions	Alkaline pH solutions

4. Cover the roller/ball with a piece of cotton or a sponge that has been dipped into a suitable lotion (according to the treatment). The lotion can also be applied directly to the skin.

- STARTING TREATMENT:**
1. Turn on “IONOS” and ensure that “I/ENERGY” regulator is set to the minimum output setting.

2. Select the operation by pressing “LEAD”.

3. Touch the treated part with the roller/ ball.

4. Slowly adjust “I/ENERGY” to the appropriate intensity at which the customer feels a gentle sting. Smoothly slide the roller. The cotton must retain its moisture all the way for the best effect.

- Always make sure customers remove any jewelry, and confirm that they have not had any metal implants (pins, joints, etc.) installed since their last treatment.

- Pregnant women and people with sensitive, injured, inflamed skin or blood capillary expansions should not receive this treatment.

- Customers with health issues such as heart disease or infectious diseases and hyper-allergic or hyper-sensitive skin (see contra-indications) may not use this instrument.

- Always make sure the skin surface has been moistened with plenty of conductive product.

- During use, the roller must not be touched by the metal pole. If any accidents happen, the instrument must be protected and the output switches off automatically. At this moment, switch off the “I/Energy” and restart it by switching on the “I/Energy”. When powering off the instrument, please switch off the “I/ Energy” first and then the “IONOS”.

Weights and sizes	Packing size (cm)	36x31x18,5
	Gross weight (kg)	3,3
	Product size (cm)	31x17/24x13
Working characteristics	Working power	5 W
	Working intensity	30 - 650 micro Am-peres
Electrical characteristics	Rated voltage	220V ~ 240V
	Frecuency	50Hz/60Hz
	Rated power	8 W

Check the following if the rollers on the probe fail to rotate.

- Dismantle and clean thoroughly.

- If the roller still fails to rotate freely, contact your sales agent.

- Take care not to damage the probe rollers. Never use abrasive substances to clean the probe rollers, since damage to the surface of the roller may scratch the surface of the skin during treatment; any damaged areas may also harbor bacteria and make sterilization more difficult.

- After treatment, all metal roller parts must be cleaned, sterilized and dried. Then store them in the accessory holder to avoid any damage.

REF.	DESCRIPTION
10004	GALVANIC HANDLE
	GALVANIC WIRES