

F-807A

Vacuum & Spray 2 In 1 Beauty Instrument

User Manual



Welcome to use this product! A0
Please read this instruction carefully before use.

About This Manual

This manual shall only be used for the reference of operation of this particular model. If the manual is used for other purposes, SILVERFOX will not undertake any according consequences and responsibility. All information of this manual shall be protected by copyright and shall not be copied and translated in any part of this specification without the written consent of our company SILVERFOX.

Safety Guidance

To ensure your correct and safe use of this product, please read all the instructions before use! Please follow all safety precautions!

	Warning!	<p>Indicates a potentially dangerous situation that, if not avoided, could result in serious loss of life.</p> <ul style="list-style-type: none">• This product is only for beauty practitioners with professional qualifications.• Do not use or store the product in a damp place such as bathroom to avoid malfunction and danger.• Do not use this product near flammable items (e.g., alcohol, thinner, gasoline, nail polish remover, sprays, etc.).• Do not use this product under the following conditions: when the power cord or plug is damaged or gets hot; when the plug in the power socket comes loose.• Do not use wet hands to plug and unplug power cord connectors and use this product.• Please make sure that the working voltage of this product conforms to its rated voltage.• Before use, make sure that the power plug and the power cord connector are fully plugged in, so as not to cause danger.• When not using this product, please turn off the power and pull out the plug.• Please regularly clean the dust accumulated on the power plug and power cord connector to avoid failure of insulation caused by moisture, dust and other factors.• Be sure to use the special power cord assembly for this product. Do not use the power cord assembly on any other appliance.• Do not wrap the power cord around the product, otherwise it may distort and malfunction the power cord.• Keep out of reach of children. Do not allow children to use this product.• Please do not modify, disassemble or repair this product by yourself. If you need to repair it, please contact the manufacturer, agent or professional maintenance personnel to check and repair it, so as not to cause danger.• Please contact distributor, service center or related personal with appropriate skill and experience for repairing if the plug is damaged, in case of any danger.
	Attention!	<p>Represents a potentially dangerous situation which, if not avoided, can result in general injury to person.</p> <ul style="list-style-type: none">• Operators should pay special attention to the safety of personnel and equipment when using.• If the product is abnormal, please stop using it immediately and contact the manufacturer or dealer for relevant treatment.• This product and related accessories should be handled lightly.• Please properly handle the packaging bag of this product to avoid accidents such as asphyxiation of infants, and keep it out of reach of children.

Product Introduction

These components are subject to change without prior notice.
Appearance of product may differ from the image.

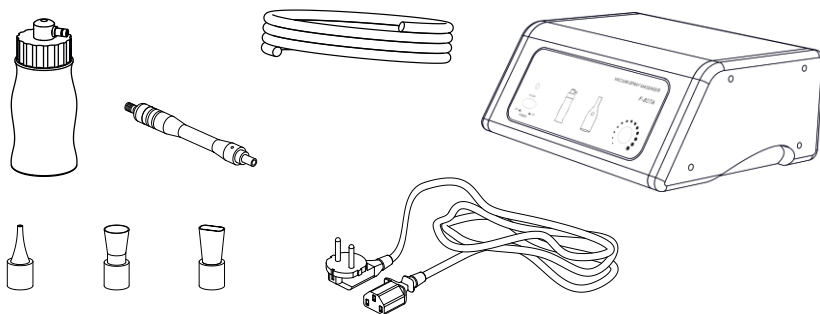

Front Panel/rear Panel

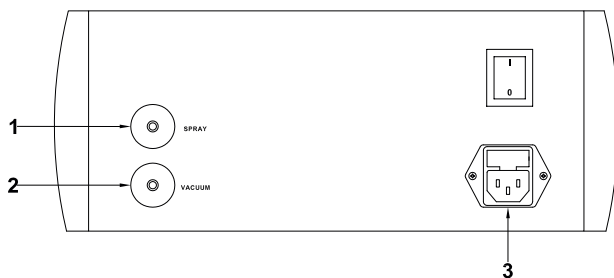
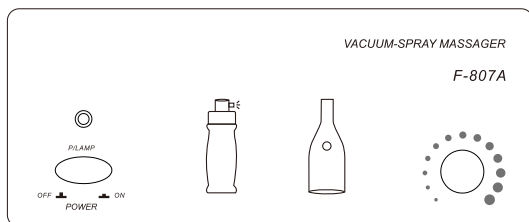

1. Spray pipe
2. Vacuum pipe
3. Feeder cable

Product Parameters

Product name	Vacuum & Spray 2 In 1 Beauty Instrument
Product model	F-807A
Product size	310×240×130(mm)
Net weight	3.8kg
Package contents	Beauty instrument ×1
	Spray bottle ×1
	Vacuum handle ×1
	Vacuum head ×1
	The power cord ×1
	User manual ×1
	Warranty card ×1
Rated voltage	AC 100-120V / 220-240V
Frequency	50/60Hz
Power	50W

Instructions Of Use

- Connect the power supply via the rear panel, indicated in the sketch as "POWER LINE INPUT".
- Connect the accessories properly to the front/rear panel as indicated in the sketch.

BLACKHEAD VACUUM

- Connect the opposite side of the pipe in the vacuum handle. Put the properly small glass vacuum pipe in the handle. There are three types of small glass vacuum pipes.

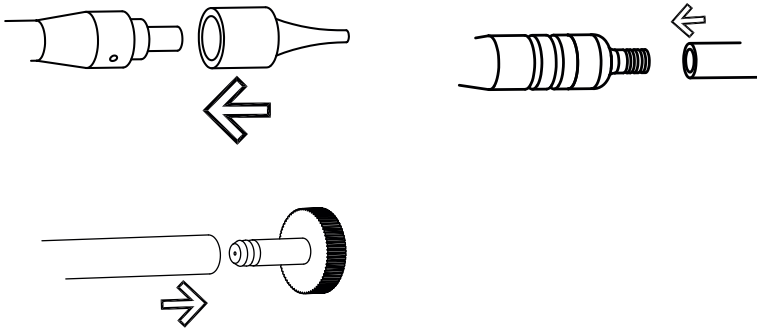

- Check that the foam filter is in its properly position in the handle.

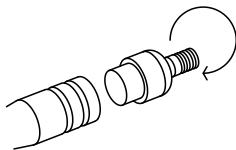

- Turn on "POWER" button in the front panel.
- You can adjust the suction effect by covering or uncovering the lateral hole of the handle with your finger.
- After performance completed, first turn off the unit by pressing "POWER" button.

NOTES

- Normal performance should not last over 5 minutes, in the event that the instrument is overheated, please turn off all buttons and restart in 10 minutes.

SPRAY

- Fill the spray bottles with the proper liquid. There are two spray bottles, which can contain different liquids.
- Connect the opposite side of the pipe to the spray bottle.
- Turn on the "POWER" button on the front panel.
- You can adjust the spray effect by covering or uncovering the top hole of the bottle with your finger.
- Once you have finished, first turn off the unit by pressing the "POWER" button.

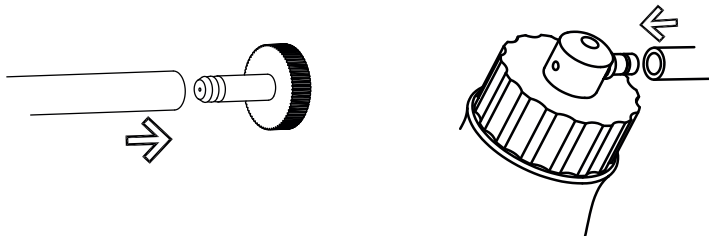

NOTES

- Spray downwards from the forehead during operation. Stop the liquid from going into the nose. Ask the customer to close their eyes and shut their mouth.
- Maintain an adequate distance from the face whilst spraying so that the effect is felt as a gentle mist landing on the skin.
- Normally the operation should not last more than 5 minutes. If the instrument overheats, turn off all the buttons and restart after 10 minutes.

Cautions

- Do not leave the handle on the same part of skin for too long since it can cause injuries.
- Avoid using in on irritated skin.
- Always make sure the spray pipe is connected to the right nozzle of the machine, to prevent accidental vacuuming of any spray solution into the pump, which can damage the pump of your machine and void your manufacturer's warranty.
- Do not work the vac/spray pump for extended periods without cool-down time between treatments in order to prevent over heating of the pump and damage to the machine. Damage caused by overheating of the pump is not covered by the manufacturer's warranty.

FAQ

If the suction effect is reduced:

- Replace the metal and foam filters.

Maintenance

The foam filter in the handle needs to be changed after every 5 treatments.
Dismantle the handle and replace the filter. Then reassemble the handle.



Do not dispose of old or defective appliances in garbage;
this should only be done through public collection sites.

- ▲ Please check the product specification before use. This manual is for reference only. Specifications are subject to change without prior notice.